

**Slant/Fin**

# VICTORY VSPH

Cast-iron sealed combustion, direct vent gas boiler

and **VSPH-NDV** power vent boiler



USGBC focuses on practices that increase a building's efficiency to harvest and use water, energy and materials.

**Modern home heating**  
with the safety, comfort and versatility of sealed combustion.

### **Venting versatility-no chimney required**

It fits easily in a closet size space and may be vented directly through a wall. It saves construction costs and allows more living space. When replacing a boiler, some old chimneys may not be adequate. Re-lining your chimney could be expensive.

*The VSPH is an ideal alternative.*

- **No chimney required**
- **Operates in total isolation from household air. Outdoor air used for combustion.**
- **Reliable, advanced design, high efficiency cast-iron heat exchanger**
- **AFUE to 86.1%—saves energy**
- **Energy Star qualified**
- **Near zero CO emissions**
- **Five sizes—60,000 to 180,000 Btuh input**



### **High efficiency keeps fuel costs low**

All Victory VSPH models are Energy Star certified by the US government for their fuel saving performance. Save 30% or more compared to a typical old boiler operating at 60% efficiency.

**THE PERFECT CHOICE FOR  
NEW RESIDENTIAL CONSTRUCTION,  
RELIABILITY AND ECONOMY.**

## Installer-friendly features

The Victory VSPH boiler installs anywhere with access to an outside wall or roof for venting— basement, utility closet or even a garage. Since it does not require a chimney, it's ideal for replacements when an old chimney is inadequate or in need of repair. It's engineered with installer friendly features to speed installation and service:

- ① **Horizontal flue discharge components** and drain tee are factory installed to save field assembly.
- ② **3-inch flue connector** with integral adapter for easy connection to stainless steel venting. Integral self-seal when used with EZ Seal components.
- ③ **Condensate drain** is built into the flue discharge assembly.
- ④ **Drain tube** for condensate is factory installed and pre-configured with water trap.
- ⑤ **Quick connect wiring** speeds service, prevents mis-wiring.
- ⑥ **Integrated boiler control with built-in diagnostics** engineered by Slant/Fin to optimize VSPH boiler operation. Diagnostic indicator lights speed trouble- shooting.
- ⑦ **Intermittent pilot spark ignition** saves energy.
- ⑧ **Field convertible gas valve** for natural-to-propane gas.
- ⑨ **Junction box** for line voltage facilitates wiring of shut-off switch.
- ⑩ **Pressure switch** functions at all altitudes.
- ⑪ **Controls, circulator pump, inducer** and other “trim” are top quality brand names that are widely available to heating professionals and easy to service.
- ⑫ **Pressure-temperature gauge** located for easy viewing.
- ⑬ **Circulator harness** is long enough for supply or return mounting.
- ⑭ **3-inch combustion air intake connector** for PVC or galvanized pipe.
- ⑮ **Air intake louvers** on NDV model for combustion air supply

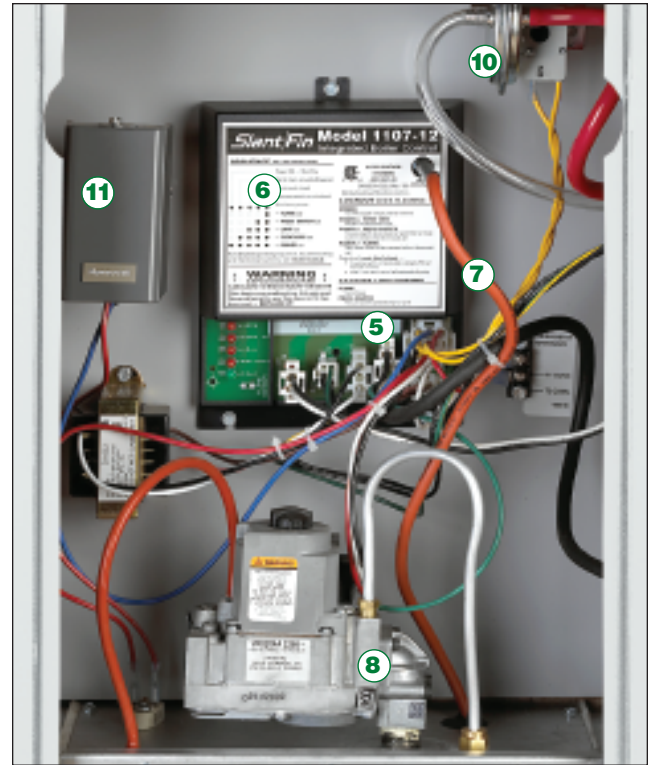
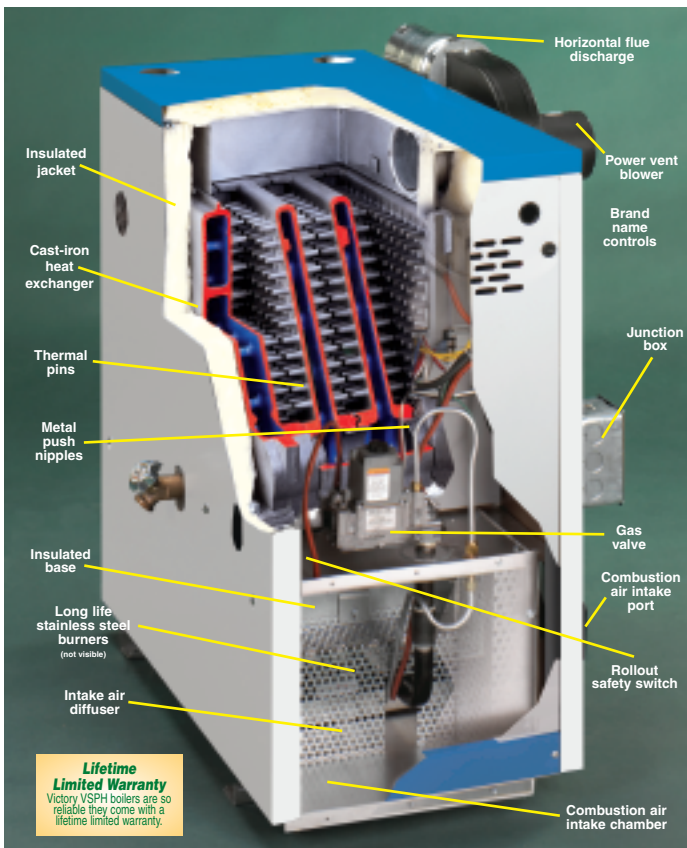

Easy to access up-front controls. Lift-off front cover.

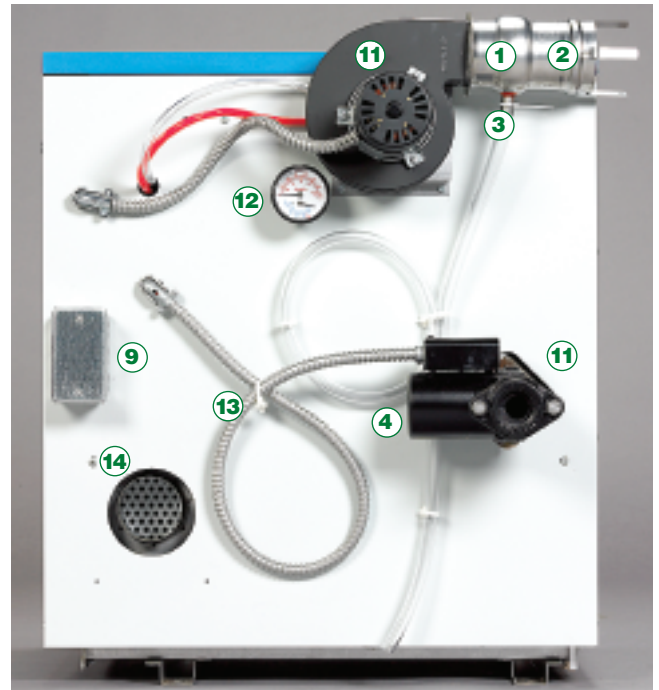

### The new VSPH-NDV power vent boiler

- Efficiency up to 86%
- Horizontal flue outlet with 3 inch connector, built-in stainless steel drain tee and other features for faster installation and easier service.
- Near zero carbon monoxide emissions
- Louvered side opening air inlet
- Uses air from inside room



# Comfort and peace of mind.



Advanced design cast-iron heat exchanger extends boiler life. Superior heat transfer properties permit use of smaller, more compact heat exchanger sections. The flue passage design, thermal pin pattern and consistent wall thickness ensure uniform heat transfer with less thermal strain and metal fatigue.



Avoid leaks with durable metal push nipples. Only metal push nipples are used to join the cast-iron sections. In many ordinary boilers, cheaper rubber or plastic gaskets are substituted for metal push nipples and could deteriorate and leak.



The electronic control was designed specifically to optimize the operation of the Victory VSPH boiler. It monitors the status of boiler components and controls the sequence of operation, including pre- and post-purge periods, trial for ignition and lockout. Five indicator lights verify normal operation and provide diagnostic information when flashing.

Heat your home with confidence with a modern new Victory VSPH boiler from Slant/Fin. High efficiency operation keeps fuel costs low. And its sealed combustion design gives you remarkable comfort, safety and peace of mind. When installed with an optional Slant/Fin indirect water heater, you can also enjoy abundant hot water for your kitchen, bath and laundry.

## Sealed combustion makes your home more comfortable

Your home will be more comfortable with a Victory VSPH boiler because it does not use household air for combustion. Two 3-inch pipes connect the boiler through an exterior wall to the outdoors. One pipe draws in fresh outside air for combustion while the other expels exhaust directly to the outdoors without ever disrupting the comfort of your living area. An ordinary natural draft boiler typically draws 20 to 60 cubic feet of warm household air per minute from your living areas. This air is replaced by cold outside air that is literally sucked in through tiny cracks and openings around doors, windows and elsewhere. This makes you chilly and causes your boiler to run longer, resulting in higher fuel bills. A properly installed system has no open flame and no vent system component that permits exhaust or flame to "back up" into the house. When the alternative non-direct venting method is chosen, inside air is used for combustion.

## Speedy, self-sealing vent connection

Flue connector has an integral seal that is compatible with Saf-T Vent EZ Seal® vent components. Integral seals speed vent installation. With EZ Seal components, no RTV sealant and no curing time are required. Drain tee on vent outlet is included at no extra charge.

## Unitized vent/air intake terminal

Designed specifically for use with the Victory VSPH boiler.

## Increased efficiency with insulated base assembly

The Victory VSPH base assembly is constructed of heavy gauge aluminized steel. Thick refractory insulation surrounds the combustion chamber, increasing efficiency. One piece stainless steel burners with special port construction resist flame lift and flashback.



Ordinary boilers consume warm household air which causes infiltration of chilly outdoor air to replace it.

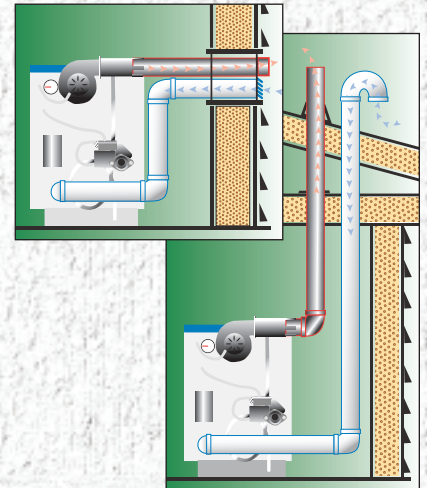

The Victory VSPH boiler operates in total isolation from household air. The combustion process is "sealed" inside the boiler, with intake air and exhaust pipes connected directly to the outdoors. Venting may be through the wall or through the roof (far right).



Self-sealing vent connection



Unitized vent/air intake terminal



Insulated Base assembly

